

FUEL FILTER

1. MOUNTING

Position the fuel filter upstream of the fuel pump using the supplied clamps. Mount the fuel filter by drilling two holes in the floor pan or frame member and attaching securely. (Note the flow direction before connecting the fuel lines.)

NOTE: The filter endcaps are machined for -10 AN O-ring fittings. Due to variations in each particular application, no fuel fittings are supplied. -10 to -8 or smaller reducers are available from most local speed shops.

WARNING: Pipe thread or any fitting other than mentioned above will cause damage to both the filter and the fitting.

2. FILTER CLEANING AND REASSEMBLY

Unthread the filter endcaps and remove the filter element and spring (make note of filter, element, endcap and spring orientation). Clean the stainless steel element by flushing clean solvent from the inside out. Repeat two or three times. Finish by blowing compressed air from the inside out until the element is dry. See graphic for assembly.

NOTE: When threading on the endcaps, use a small amount of oil on the O-rings for lubrication.

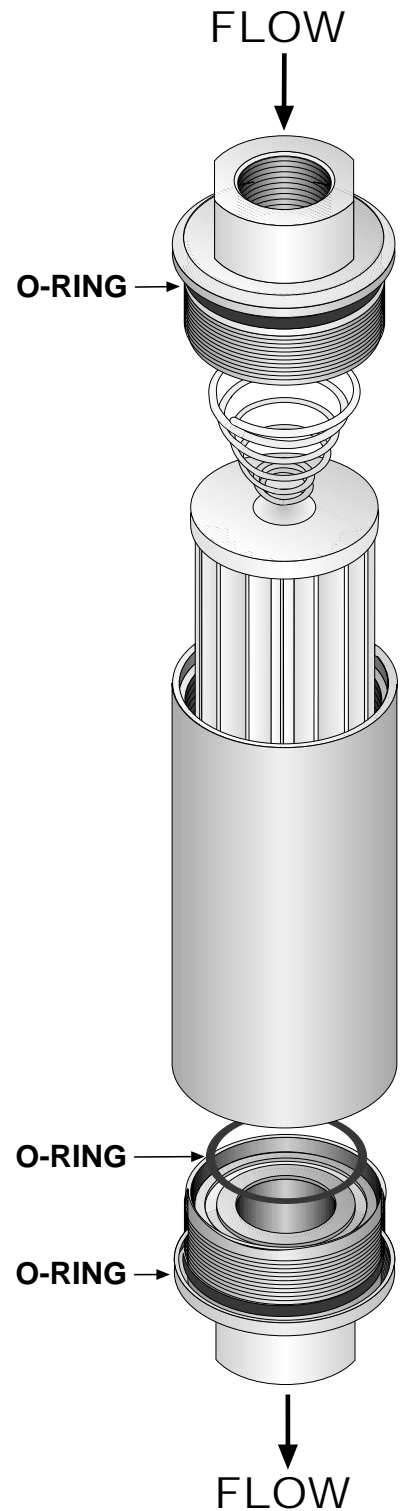

© 1995 VORTECH® ENGINEERING, INC.
all rights reserved